

## **AUTOMATIC ICE MAKER ICM80**



**To ensure your safety and the correct use of this device, please read the following instructions carefully before operating it.**



## Contents

1 - Important safety instructions	3
2 – Features	5
3 - Notes before operation	5
4 – Structure	5
5 – Operation procedures	6
6 – Maintenance	7
7 –Trouble and shooting	9
8 – Electrical wiring	10
9 – Exploded view – spare parts	11



## 1- Important safety instructions

### Important Safety Tips :

When using electrical appliances, basic safety precautions should be followed to reduce the risk of fire, electric shock, and injury to persons or property. Read all instructions before using any appliance.

This appliance can be used by children aged from 8 years and above and persons with reduced physical, sensory or mental capabilities or lack of experience and knowledge if they have been given supervision or instruction concerning use of the appliance in a safe way and understand the hazards involved. Children shall not play with the appliance. Cleaning and user maintenance shall not be made by children unless they are older than 8 and supervised.

If the power cable is damaged, it must be replaced by the manufacturer, its service agent or similarly qualified persons in order to avoid a hazard. Do not store explosive substances such as aerosol cans with a flammable propellant in this appliance.

When disposal of the appliance, it must be done by the manufacturer or its service agent or a similarly qualified person in order to avoid fire and other hazard.

E.g. Please accord to local regulations regarding disposal of the appliance for its flammable refrigerant and blowing gas. Before you scrap the appliance, please take off the doors to prevent children trapped.

The appliance shall be disconnected from its power source during cleaning or maintenance and when replacing parts, the removal of the plug has to be such that an operator can check from any of the points to which he has access that the plug remains removed.

**WARNING:** Keep clear of obstruction all ventilation openings in the appliance enclosure or in the structure for building-in.

**WARNING:** Do not use mechanical devices or other means to accelerate the defrosting process, other than those recommended by the manufacturer.

**WARNING:** Do not damage the refrigerating circuit.

**WARNING:** Do not use electrical appliances inside the food/ice storage compartments unless they are of the type recommended by the manufacturer.

**WARNING:** When positioning the appliance, ensure the supply cord is not trapped or damaged.

**WARNING:** Do not locate multiple portable socket-outlets or portable power supplies at the rear of the appliance.

**WARNING:** Connect to potable water supply only .

When replace detachable hose-sets, the new hose-sets supplied with the appliance are to be used and that old hose-sets should not be reused.

The minimum inlet water pressure is 0.15MPa. The maximum inlet water pressure is 0.5MPa.

**Warning :** risk of fire / flammable materials



Refrigerant R600a / R290, this gas is natural gas with high environmental compatibility that is, however, also combustible. When transporting and installing the appliance, care should be taken to ensure that no parts of refrigerating circuit are damaged.

Refrigerant leaked from the refrigerating pipes could ignite, if leaking is detected, to avoid any potential source of ignition (spark, naked flames etc.), please open window or door, and keep good ventilating.

Correct disposal of this product



This marking indicates that this product should not be disposed with other household wastes throughout the EU.

To prevent possible harm to the environment or human health from uncontrolled waste disposal, recycle it responsibly to promote the sustainable reuse of material resources.

To return your used device, please use the return and collection systems or contact the retailer where the product was purchased. They can take this product for environmental safe recycling.

## 2 - Features

The ICM80 Automatic ice maker's have a streamlined design with a stainless steel flat front panel door. These units are designed to operate in tropical conditions and the ice making processes is automatically controlled for continual use. The ice storage cabinet is PU foamed, for better insulation.

## 3 – Notes before operation

1. The incline angle of the cabinet should not be over 45° during transportation. Don't transport the unit upside-down Make sure the machine is level.
2. On initial startup or when restarting after a long period of storage, the ice made for the first two cycles needs to be discarded.
3. The ice maker should be placed on a level horizontal / solid surface and away from any heat source or corrosive gas. The unit is front venting but for optimal efficiency. At least about 150mm space should be left to ensure better ventilation.
4. Adjust the feet to level the unit or this may affect the internal water level and thus the shape of the ice that is produced.
5. Allow the unit to stand for approx. 12 hours before initial startup.
6. The outlet of drainage should be lower than cabinet to allow proper drainage. At least 100mm below the unit.
7. The separate three-pin 15AMP electrical socket should be used.

## 4 - Structure

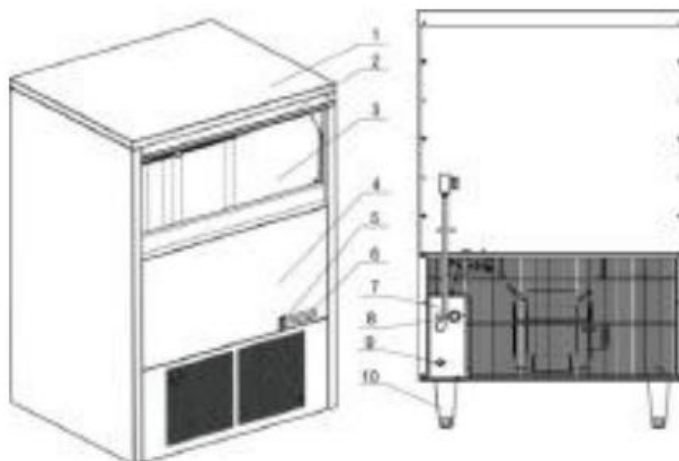

- 1- Top Panel
- 4- Front panel
- 7- Power cord
- 10- Adjustable feet

- 2- Door
- 5- Power switch
- 8- Water inlet valve

- 3- Ice storage bin
- 6- Display panel
- 9- Drainage tube

Install the water inlet system as following:  
A→B→C→D→E→F

- A : Pressure reducing valve; diameter 1/2"
- B : Connector; diameter 1/2"
- C : Water Filter inlet pipe; diameter 1/2"
- D : Water filter
- E : Water Filter outlet pipe; diameter 3/4"
- F : Water inlet valve; diameter 3/4"
- G : Drain Valve, Drain outlet must be lower

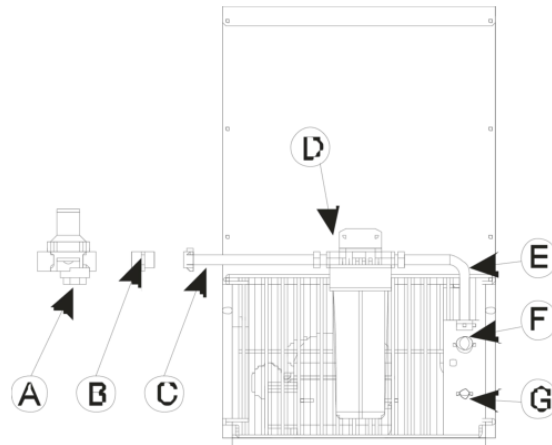

## 5 - Operation procedures

1. Unpack the ice maker from its carton, then remove the ice shovel. Remove inlet/outlet tubes, and sealing washers, from the container in the ice maker where they have been stored for transit.
2. Install the ice maker in a well ventilated place, leaving at least a 150mm gap between the ice maker and the walls/ceiling etc. The ice maker must be level, and situated away from any heat source.
3. Attach one end of the  $\phi 12$ mm flexible plastic corrugated pipe to the water outlet on back of machine. The other end of the pipe should be inserted into a plumbed in stand waste pipe, 100mm below the unit.
4. Connect the 3/4" water inlet hose, supplied with the ice maker, to a drinking water supply and then connect the other end to the water inlet on the back of the machine. When connecting this hose, use the sealing washers supplied with the ice maker to eliminate the risk of a water leak. The water pressure must be a minimum of 1Kg/cm<sup>2</sup> or 14.7 psi and a maximum of 8 kg/cm<sup>2</sup> or 117psi.
5. Plug the power lead in to the supply socket, then press the green on/ off switch on the ice maker to start it, the green "run" light will be lit. The ice maker will start to operate.
6. The operation of the ice maker is completely automatic unit the ice is removed from the container. Water supply-ice making-ice transfer-ice storage.
7. If the storage container is full with ice, the "ice full" indicator on the display panel will light, and the ice maker will stop automatically. Remove the ice from the storage container, wait for five minutes, then restart the ice maker.
8. Should the water supply be restricted or fail, the "water low" light will be lit. The ice maker will stop automatically. When the water supply is restored, wait for at least five minutes then re-start the ice maker.



## 6 - Maintenance

1. If the compressor stops for any reasons like water shortage, too much ice, power off, etc. Don't restart it right away. Wait 5 minutes to restart this will protect the compressor.
2. Regularly check the connectors of the water inlet and outlet pipes. Drain any surplus water.
3. If the ice maker is not being used for a long period, please screw off the plastic drainage connector on the back of the ice maker and drain the surplus water in the water groove. Then reconnect. Wipe the inner liner of the ice storage container with a clean rag.
4. Don't remove the plug from the electrical socket by pulling on the electrical cord.
5. Clean the ice maker and its water supply system at least once month. The ice maker should be unplugged before cleaning.
6. Clean condenser at least twice a year. Remove front panel and blow out with a hair dryer.
7. Automatic cleaning: Fill some ice maker special cleaning fluid into the water box. Power on and press the clean button to start the cleaning progress. The clean indicator light will flash in the process. Automatic cleaning process will last 30 minutes and it can not be break unless you power off the machine. After finished, drain the water box. Start the automatic cleaning process again without cleaning fluid. If necessary, repeat it one more time to rinse the residual cleaning fluid.
8. Drainage: Pull out the drainage plug at the bottom of the water box, after the water drained away, install it back.

How to clean the spray water system ?

	<ol style="list-style-type: none"> <li>1. Remove the block water board.</li> <li>2. Pull out the ice flopping shelf.</li> </ol>
	<ol style="list-style-type: none"> <li>3. Take off the spray pipe connection ( the silicone tube ) then take out the spray pipe.</li> </ol>
	<ol style="list-style-type: none"> <li>4. Remove the spray nozzles and the nozzle clamps as the direction one by one.</li> <li>5. Wash the spray pipe and the nozzles with a soft brush.</li> </ol>
	<ol style="list-style-type: none"> <li>1. Take out the spray pump.</li> <li>2. Step 1: Unscrew the top plate from back, and remove it as the direction.</li> <li>8. Step 2: Remove the back plate as the same.</li> </ol>
	<ol style="list-style-type: none"> <li>9. Step 3: Unplug the spray pump.</li> <li>10. Step 4: Unscrew the pump cover as the direction.</li> <li>11. Step 5: Pull out the pump assembly.</li> </ol>
<p>Pump Filter Net</p>	<ol style="list-style-type: none"> <li>12. Pull out the pump filter net as the direction.</li> <li>13. Wash the filter net with a soft brush.</li> <li>14. Reinstall all the parts.</li> </ol>





## 7 – Trouble and shooting

TROUBLE	CAUSE	REMEDY
The ice maker does not work.	<ol style="list-style-type: none"> <li>1. The voltage is out of the limitation,</li> <li>2. The ambient temperature</li> </ol>	<ol style="list-style-type: none"> <li>1. Stop the ice maker and restart.</li> <li>2. Try again when the ambient temperature higher than 10°C.</li> </ol>
Water shortage indicator lights on.	<ol style="list-style-type: none"> <li>1. Water shortage from the water supply system.</li> <li>2. Water valve damaged.</li> <li>3. Tap water pressure too low.</li> </ol>	<ol style="list-style-type: none"> <li>1. Check the water supply. If it is OK, restart the maker.</li> <li>2. Check the water valve.</li> <li>3. Ensure water pressure is higher than 1Kg/cm<sup>2</sup>.</li> </ol>
Compressor does not work.	<ol style="list-style-type: none"> <li>1. Water shortage.</li> <li>2. Ice full.</li> </ol>	<ol style="list-style-type: none"> <li>1. Check the water supply system (water valve and water supply tube).</li> <li>2. Take out some ice.</li> </ol>
Compressor works, but no ice is made.	<ol style="list-style-type: none"> <li>1. Refrigerant leakage.</li> <li>2. The refrigerating system is blocked.</li> </ol>	<ol style="list-style-type: none"> <li>1. Recharge the refrigerant and check the again.</li> <li>2. Check whether the system is blocked and replace the dryer-filter.</li> <li>3. Replace the solenoid valve.</li> <li>4. Check whether the fan is running.</li> </ol>
Ice is not dropping.	<ol style="list-style-type: none"> <li>1. Water temperature or ambient temperature is too low.</li> <li>2. The solenoid valve is damaged.</li> </ol>	<ol style="list-style-type: none"> <li>1. Check whether the ambient temperature is too low. (Lower than 10°C) or water temperature is too low (lower than 7°C).</li> <li>2. Replace the solenoid valve.</li> </ol>
Trouble indicator lights on.	The water box does not tilt.	Unplug the power. Check the tilting motor and the relative system. 3-5 minutes later restart the machine.

## 7 – Electric wiring

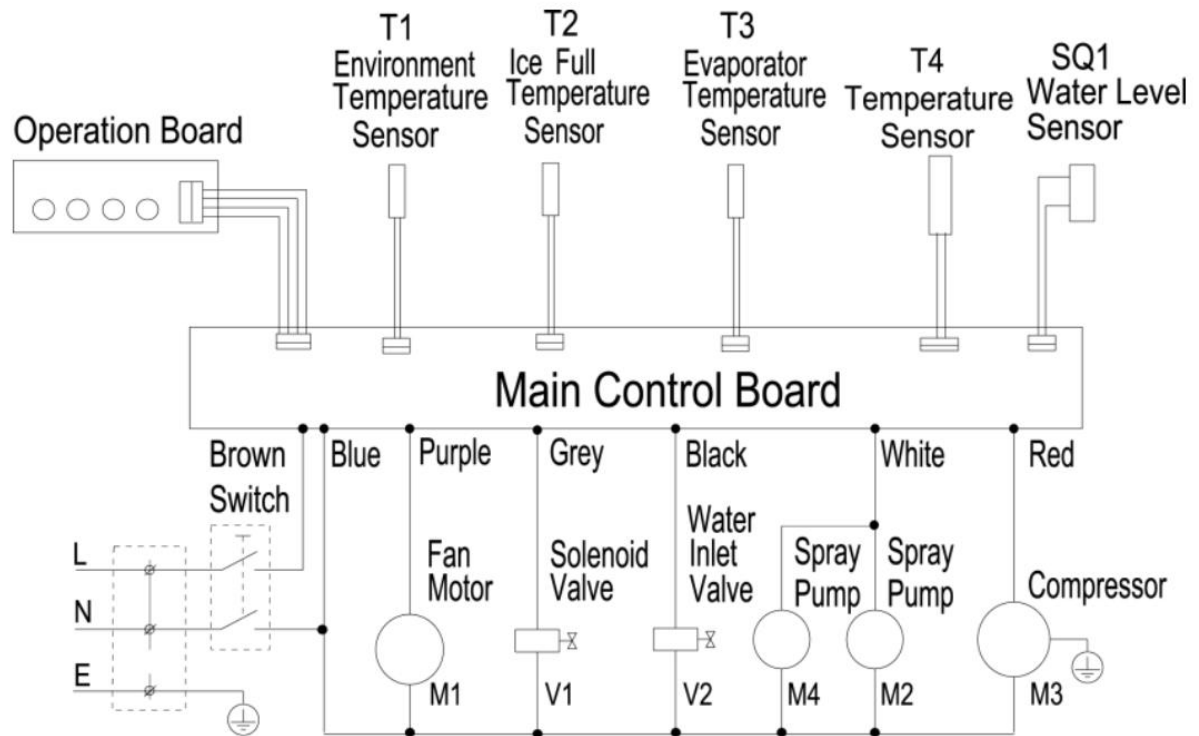



## 7 – Exploded view and spare parts

No.	Selon Parts ID	Description	QTY	Wearing Parts
1	02020000344	Inner Liner	1	
2	13010900033	Ventilation Panel	1	
3	13030500478	Fixer Board for Down Panel	1	
4	04040230001	Operation Panel	1	Yes
5	10020300023	Sticker of Operation Panel	1	Yes
6	05140000050	Power Switch	1	Yes
7	13030700072	Down Panel	1	
8	02010000478	Door	1	
9	13030500012	Top Cover Blocking Piece	2	
10	07100000035	Ice Full Sensor Fixer Tube	1	
11	05200000046	Ice Full Sensor	1	Yes
12	13030502869	Fixer Board for Side Panel	1	
13	02050000975	Water Drainage Valve	1	Yes
14	02050001003	Water Holding Axis	1	
15	02050001889	Water Shower	1	
16	13030800689	Blocking Panel	1	
17	11010000024	T Type Cape	2	
18	15010000354	Ice Flopping Shelf (Ice Shape 33*33*33mm)	1	
19	11100000300	Evaporator Cover	1	
20	08050200043	Cotton Insulation for Top Cover	1	
21	13011200035	Top Cover	1	
22	14020000516	Evaporator	1	
23	05200000029	Evaporator Sensor	1	Yes
24	11110000265	Water Box	1	
25	02050001634	Pump Set	1	
26	11060500001	Water Shower Connector	2	
27	05200000039	Ambient Temp Sensor	1	Yes
28	13030200540	Back Panel	1	
29	14030500038	Suction Tube Set	1	
30	04090000072	Magnetic Valve	1	Yes
31	11110000033	Control Box Cover	1	
32	11110000032	Control Box	1	
33	04040310193	Main Control Board	1	Yes
34	14030200045	T Type Connector	1	
35	14030200279	Discharge Tube	1	
36	11060500026	Backwater Pipe Connector	1	
37	11060400012	Nut of Backwater Pipe Connector	1	
38	11090000095	Seal Washer of Drainage Connector	1	
39	11060500058	Backwater Elbow	1	
40	11060100221	Backwater Pipe	0,16	



41	02050000976	Water Supply Pipe	1	
42	15020000011	Metal Grill	1	
43	04090000067	Water Inlet Valve	1	Yes
44	13030502855	Water Valve Fixer Panel	1	
45	04020200023	Power Cord	1	
46	07030000046	Power Cord Fixer	1	
47	11060100053	Water Recycling Tube	1	
48	11060500008	Ice Water Drainage Connector	1	
49	11060100049	Ice Water Drainage Pipe	1	
50	07040000045	Feet	4	
51	14030300029	Filter	1	
52	11020000042033	Filter Fixer	1	
53	04070300074	Compressor	1	
54	13010500122	Compressor Fixer Board	1	
55	04010100221	Fan	1	
56	05200000028	Condenser Sensor	1	Yes
57	14010000067	Condenser	1	
58	11110000102	ice scoop	1	Yes
59	11060100037	Drainage Pipe	1	Yes
60	11090000098	Seal Washer for Water Inlet Tube	2	
61	11060100059	Water Inlet Tube	1	
62	11060100060	Water Inlet Tube	1	
63	11110000140	Water Filter	1	

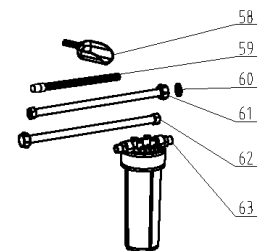
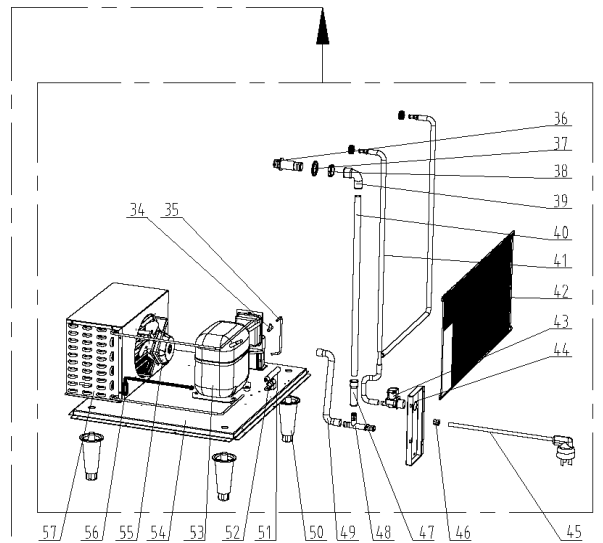
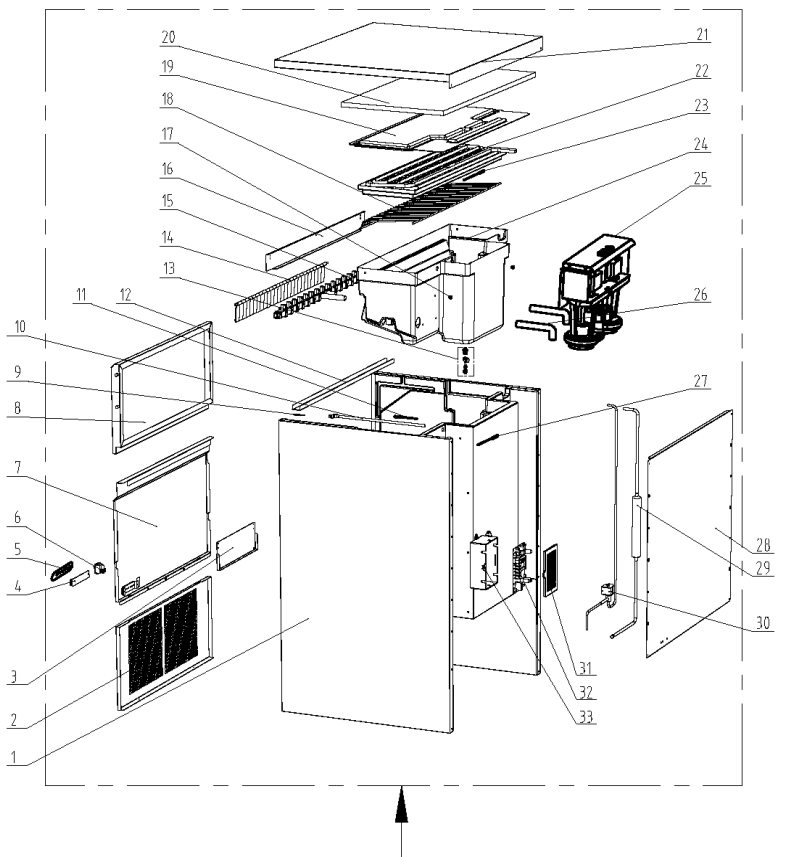



CE